

Field Avenue, Canterbury, Kent, CT1 1TS

£1,400 Per Month





## Field Avenue

### Canterbury CT1 1TS

This fabulous 2 bedroomed semi detached simply has to be viewed to appreciate the generous sized plot and modern feel offered throughout. The house is presented to a high standard and boasts modern fittings throughout and a superb open plan feel. If you are looking from a house with a large garden with the benefit of two vegetable gardens for growing your own produce should this be on your radar. The house boasts a wrap around plot and although no parking is offered, there is plenty of on street parking in front of the property and is not an issue. This property is ideally tucked away and accessed via a walkway from Field Avenue. The double glazed entrance door opens into a bright and airy lounge which is open plan to a modern fitted kitchen / dining room. On the first floor are the two bedrooms and family bathroom. For any further information or to arrange a viewing, please call or email Sally Hatcher Estates.

Rent £1400 per month

Deposit £1615.38

Available Now

Council Tax Band B Canterbury City Council

No smokers

Pet friendly ( house trained).

Please refer to the fee's tab on our website ([www.sallyhatcher.co.uk](http://www.sallyhatcher.co.uk)) for all information on fee's and deposit options







Floor Plan

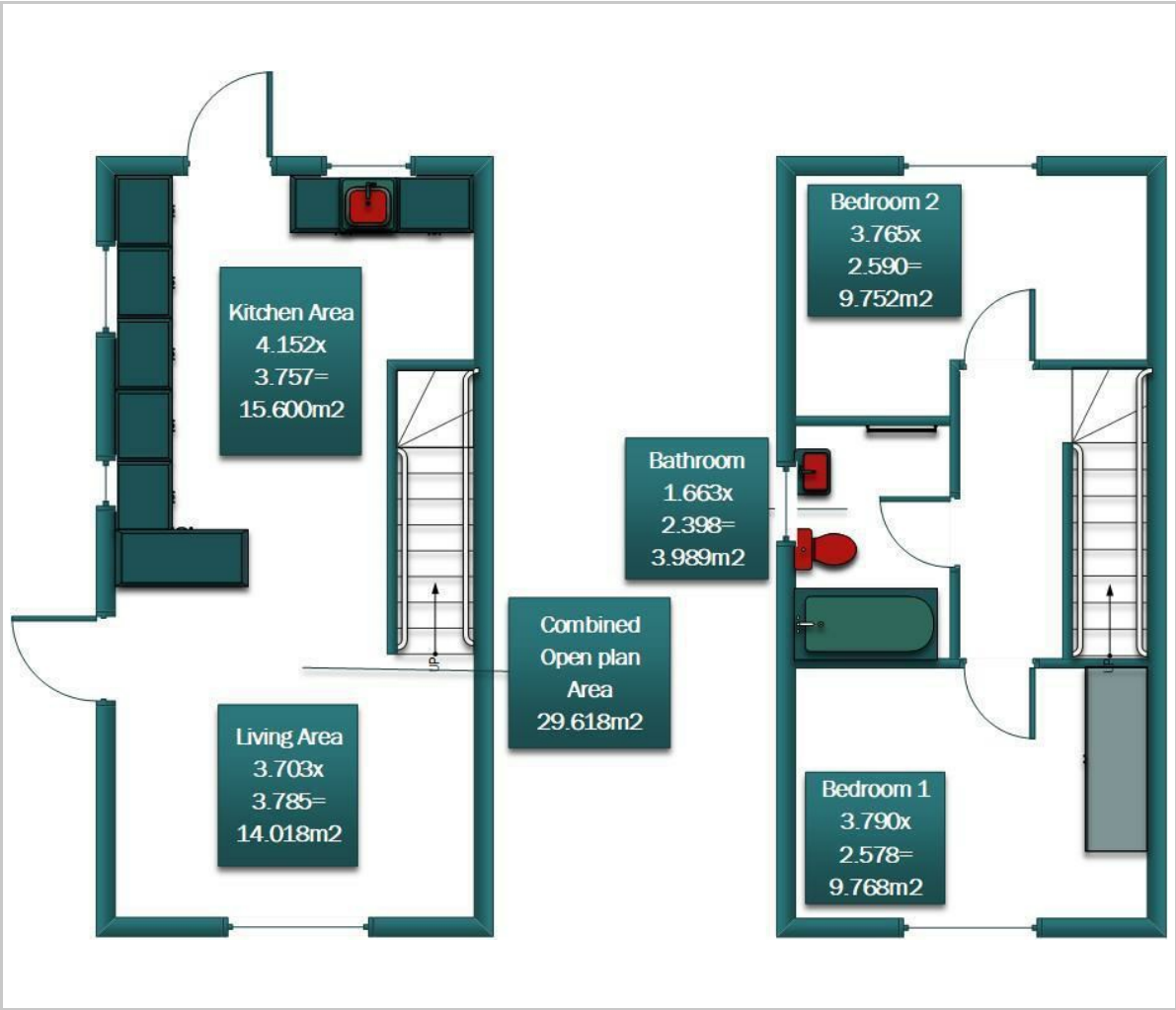

Viewing

Please contact us on 01227 733888 if you wish to arrange a viewing appointment for this property or require further information.

These particulars, whilst believed to be accurate are set out as a general outline only for guidance and do not constitute any part of an offer or contract. Intending purchasers should not rely on them as statements of representation of fact, but must satisfy themselves by inspection or otherwise as to their accuracy. No person in this firms employment has the authority to make or give any representation or warranty in respect of the property.

Area Map

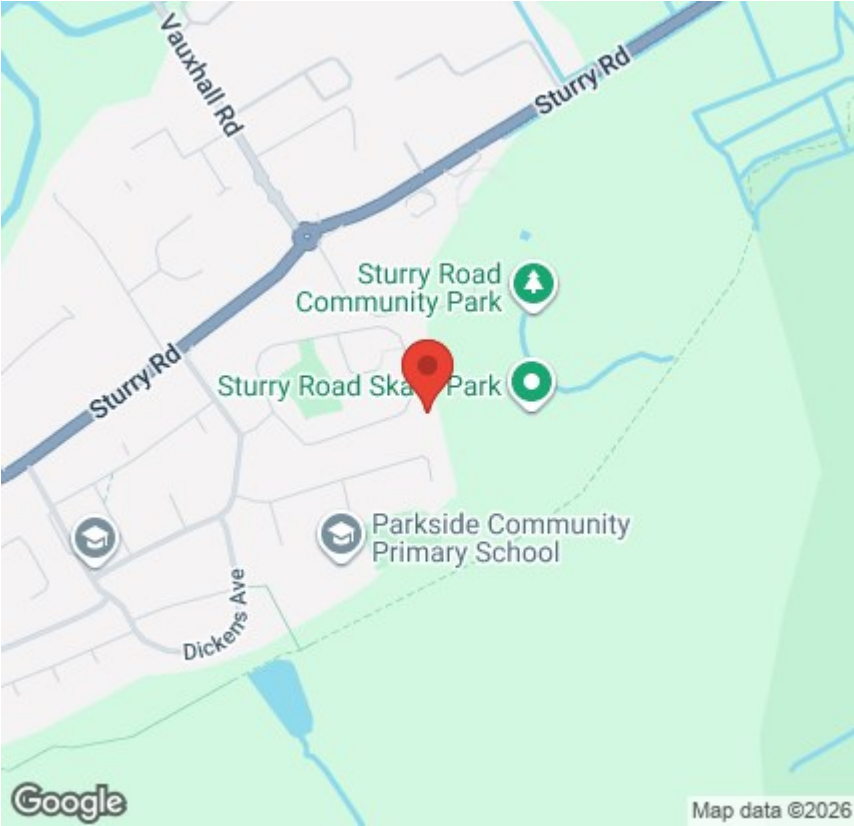

Energy Efficiency Graph

